

TRAFFIC NOTES

TRENCHING / EXCAVATING

The following notes shall apply to excavations of trenches or pits that are located in the pavement or are within six (6) feet of the edge of roadway:

- 1.) Trench walls shall not be closer than three (3) feet from the edge of the traveled way at any stage of construction.
- 2.) Traffic control devices shall be in place before starting any excavation.
- 3.) Trenches or pits will not be permitted to be bridged by steel plates and open to traffic unless they are temporarily backfilled to finished street grade.
- 4.) For pits or trenches along or in a roadway that are going to be left open over night that are zero to fifty (0 - 50) feet in length, the following applies. GUARD RAIL OR CONCRETE BARRIER SHALL BE USED.
- 5.) For pits or trenches along or in roadway that are going to be left open over night and are longer than 50 feet in length. CONCRETE BARRIERS MUST BE USED.
- 6.) Plastic construction fencing shall be required for any trench or pit left open over night.
- 7.) When using any guardrail or concrete barrier, protected end must be used as per the TEXAS-M.U.T.C.D.
- 8.) For vertical drop-offs greater than two (2) feet along roadway, low profile concrete with appropriate end protection must be installed.
- 9.) All concrete barriers placed on City R.O.W shall be low profile. No high profile barriers will be allowed.

REFLECTIVE SHEETING

The reflectorized white and reflectorized orange stripes for channelizing devices such as barricade drums and vertical panels shall be constructed of reflective sheeting meeting the color and retro-reflectivity requirements of high intensity, unless otherwise specified in the plans.

MAINTENANCE

- 1.) All traffic signs shall be kept in proper position, clean and legible at all times. Damaged barricades, signs, and other traffic control devices shall be replaced without undue delay.
- 2.) To ensure adequate maintenance, a suitable schedule for inspection, cleaning, and replacement of barricades, lights, and signs shall be established.
- 3.) Special attention and necessary action shall be taken to see that weeds, trees, shrubbery and construction materials do not obscure the face of any sign or barricades.

TRAINING

Each person whose actions affect maintenance and construction zone safety, from the upper-level management personnel through construction and maintenance field personnel, should receive training appropriate to the job decision each individual is required to make. Only those individuals who are qualified by means of adequate training in safe traffic control practices and have a basic understanding of the principles established by applicable standards and regulations, including those of the TEXAS M.U.T.C.D. should supervise the selection, placement, and maintenance of traffic control devices in maintenance and construction areas.

SPECIAL EVENTS BARRICADING

All Type I, (8') barricades used for special events (Dome, Runs, Walks, Parades etc.) shall be a minimum of 42" high and 96" wide. Any necessary signs will require proper sign stands.

USE OF CITY R.O.W.

The City of San Antonio reserves the right to allow contracting and barricading sub-contractors to use the City's R.O.W. The City also reserves the right to advise contractors and barricading sub-contractors to remove stored or unused traffic control devices from the City of San Antonio R.O.W. It is the barricading sub-contractor's responsibility to remove any traffic control device from City's R.O.W. when instructed to do so by a City representative.

CLOSURE DIAGRAMS

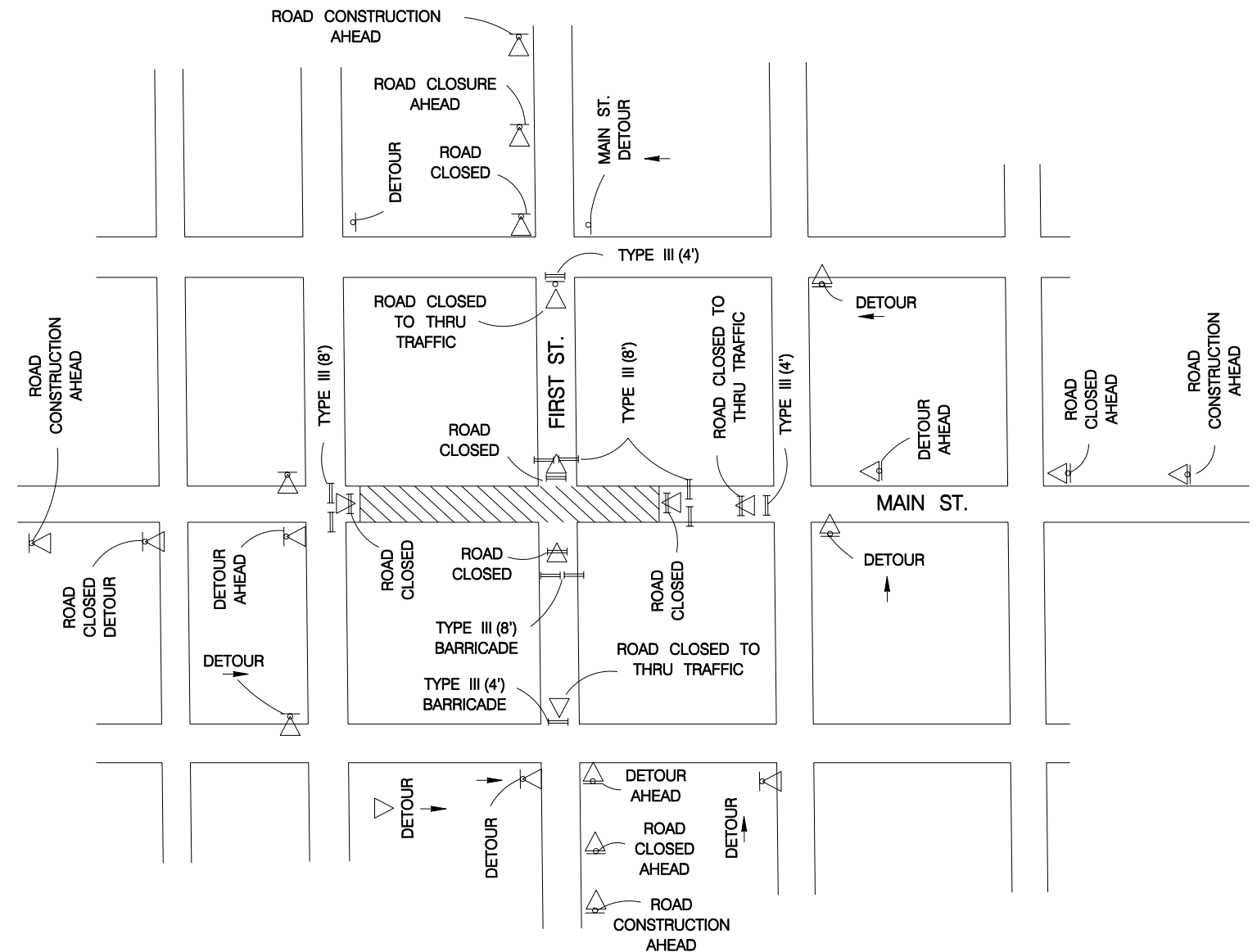

TYPICAL INTERSECTING STREET CLOSURE FOR TWO LANE STREETS

NOTE:
ALL SIGNS WILL BE MOUNTED ON SIGN SUPPORTS ONLY

THE ORIGINAL OF THIS DRAWING WAS SIGNED AND SEALED BY JOHN D. FRIEBELE, #46394 ON 06-20-05 AND IS ON FILE WITH THE TRAFFIC ENGINEERING DIVISION OF THE PUBLIC WORKS DEPARTMENT, CITY OF SAN ANTONIO.

JUNE 2005

CITY OF SAN ANTONIO
DEPARTMENT OF PUBLIC WORKS

TRAFFIC STANDARDS
BARRICADE AND CONSTRUCTION STANDARDS
SHEET 1 OF 4

DRWN. BY: A.F.G.	DSGN. BY: E.N.M.	CHKD. BY: J.D.F./E.N.M.	SHEET NO. OF
------------------	------------------	-------------------------	--------------